

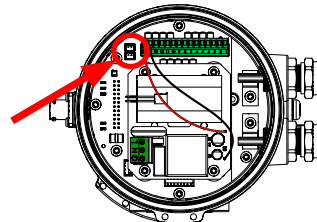

## Wiring

On the back of the meter, unscrew the black user access lid and remove it. Remove the 15 pin screw connector from its bag. Install the wires through the cable ports into the 15 pin screw connector in their respective locations. Plug the 15 pin screw connector into its socket. **Be sure all pins align properly and that the connector has not slipped to one side.** Refer to the complete manual for further details. (C1 = power/output cable, AC = AC power cable)

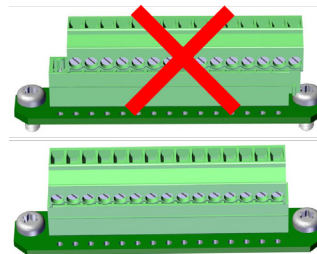
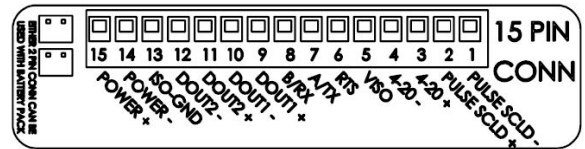
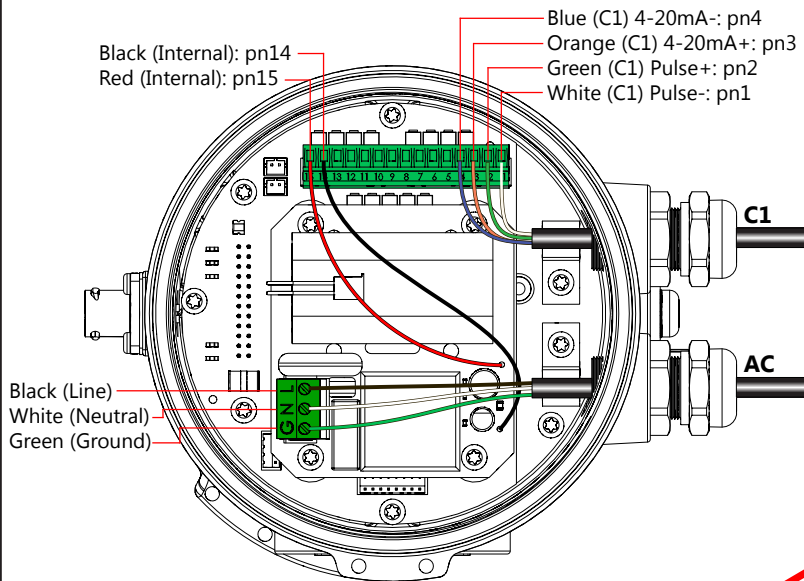

**WARNING: BACKUP BATTERIES ARE NOT INTENDED AS A PRIMARY POWER SOURCE**



**WARNING:** Improper sealing of glands or cables will invalidate any warranty. If plugs or cable glands are removed, reinstall using Teflon pipe sealant, or tape, to ensure maximum moisture protection.



Remove plug & o-ring. Insert cable gland/strain relief. Feed cable through cable gland.

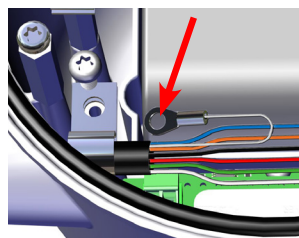

Clamp cable with strain relief clips. Attach drain wire lug to bracket post.

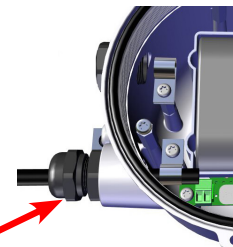

**CRITICAL!**  
Torque cable gland sealing nut to 22 in-lbs.

Refer to the **Mechanical Quick Start Guide** or the complete instruction manual for details on mechanical installation.

## Menu System



The **HOME Screen** displays flow volume, direction of the flow total and flow RATE along with status conditions such as Empty Pipe. Two buttons below the LCD display are used to access menu screens for viewing and changing meter setup parameters.

These two buttons are light sensors which can detect when a finger is covering them. Only three button touch actions are needed to control navigation through the menus, settings changes and back to the home screen.



### HORIZONTAL SCROLLING:

Tap right-hand button to scroll horizontally through menu tabs or move horizontally within a tab dialog when applicable.



**SELECT:** Tap left-hand button to change a highlighted item within a tab dialog.



**ENTER/EXIT:** Hold left button while tapping right button once to enter or exit a tab dialog or to navigate between the HOME and other menu screens.

All menu screens consist of two rows of tabs surrounding a dialog box that lets you view and change setup parameters. To enter the Menu System perform the hold and tap sequence.



## Changing Settings

### T UNIT

View or change TOTAL volume units

T UNIT	R UNIT	SET P	DAMP
TOTAL = GALLONS			
PRESS  +  TO SET TOTAL UNITS FOR DISPLAY			
SET 4	SET 20	SET F	EXIT

### R UNIT

View or change flow RATE units

T UNIT	R UNIT	SET P	DAMP
FLOW RATE = GALLONS/MIN			
PRESS  +  TO SET RATE UNITS FOR DISPLAY			
SET 4	SET 20	SET F	EXIT

### Set P

View or change pulse output scaling

T UNIT	R UNIT	SET P	DAMP
00001.0 GALLONS			
PRESS  +  TO SET GALLONS TOTALIZED PER PULSE SENT OUT PULSE1			
SET 4	SET 20	SET F	EXIT

### DAMP

View or change # of samples for rolling average.

T UNIT	R UNIT	SET P	DAMP
DAMPING = 1			
PRESS  +  TO SET DAMPING VALUE			
SET 4	SET 20	SET F	EXIT

### SET 4

View or change flow rate corresponding to 4mA

T UNIT	R UNIT	SET P	DAMP
00040.0 GALLONS/MIN			
PRESS  +  TO SET FLOW RATE AT WHICH 4mA (MIN) OUTPUT IS DESIRED			
SET 4	SET 20	SET F	EXIT

### SET 20

View or change flow rate corresponding to 20mA

T UNIT	R UNIT	SET P	DAMP
00200.0 GALLONS/MIN			
PRESS  +  TO SET FLOW RATE AT WHICH 20mA (MAX) OUTPUT IS DESIRED			
SET 4	SET 20	SET F	EXIT

### EXIT

Return to HOME SCREEN or enter SUBMENU

T UNIT	R UNIT	SET P	DAMP
PRESS  +  EXIT MENU AND RETURN TO FLOW DISPLAY			
SET 4	SET 20	SET F	EXIT

The **EXIT** tab in the MAIN MENU has a second function. If you tap five times, you will be redirected to a SUBMENU screen from which you can access additional options.

**INFO:** Meter model, serial number, firmware version  
**HPOLL:** HART address