

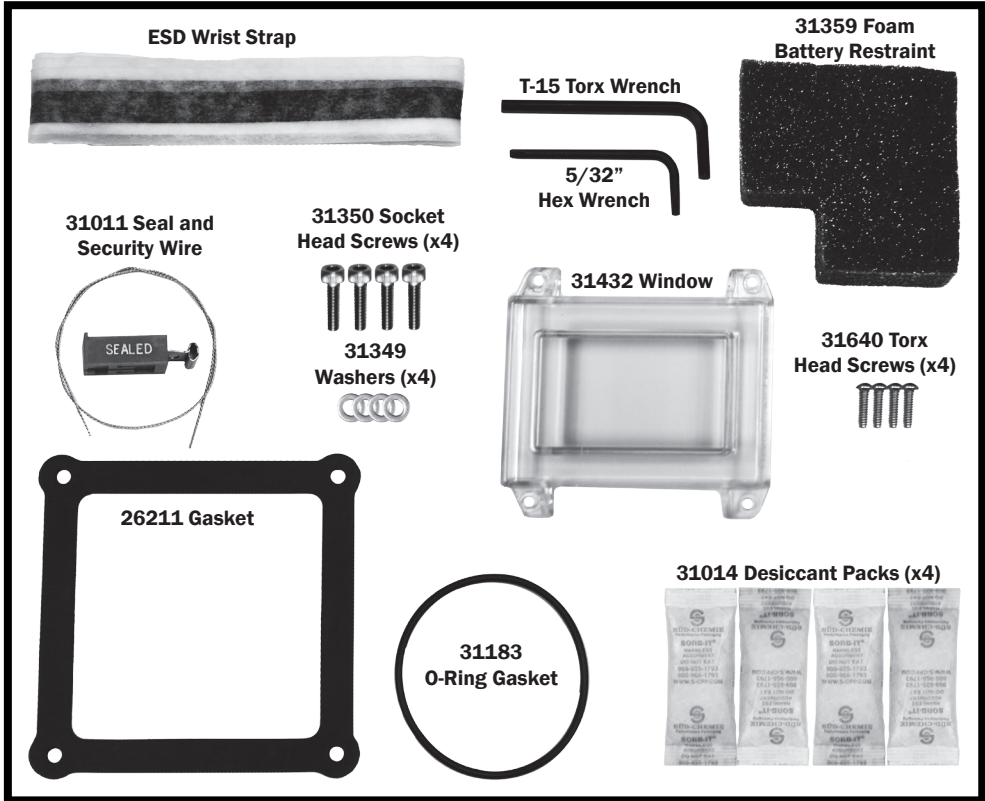

Window Replacement Kit

For AG2000 & WMX Magmeters



Your window replacement kit comes with the following (shown above):

T-15 Torx Wrench
5/32" Hex Wrench
ESD Wrist Strap
26211 Seal Gasket
31011 Security Seal and Wire
31014 Desiccant Packs
(Keep Desiccant Packs in bag until ready to install)

31183 O-ring Gasket
31349 Washers (x4)*
31350 Socket Head Screws (x4)*
31359 Foam Battery Restraint
31432 Window
31640 Torx Head Screws (x4)*

*Screws and washers are provided to replace parts that may be lost during window replacement

LCD Window Replacement Procedure for AG2000 & WMX



WARNING:

Before removing the top cover, take precautions to prevent any moisture or wind blown dust from getting into the enclosure while the cover is off.

MOISTURE IN THE METER WILL CAUSE METER FAILURE.

NOTE: In order to protect the electronics from electrostatic damage, put on an ESD wrist strap (supplied) and attach it to a ground or the lug for the equalization straps on the side of the meter housing.

Remove Damaged Components (9 steps).

- 1)** If used, cut the security wire and remove. Remove the 4 screws from the top cover using a 5/32" hex driver (supplied).
- 2)** Gently pry off the top cover assembly using a blunt screwdriver blade at one of the cover corners. Prying at the corner reduces the likelihood of damaging the sealing portion of the gasket. Lift off the top cover, taking care not to stress the ribbon cable connecting the internal assemblies.
- 3)** Slip the battery out of its molded tray and gently unplug the battery. Memory will not be lost when the battery is removed. The previous total will appear after the meter has been restarted.
- 4)** Do not remove the battery tray as this will alter the calibration of the meter.
- 5)** Using a T-15 Torx driver (supplied) remove the four #6 screws holding the circuit board to the top cover. Removing the ribbon cable from the upper board by opening the clips and pulling up on the cable connector may ease the rest of this procedure but is not required.
- 6)** Remove the 26211 Gasket from the top cover and remove any adhesive that may have transferred to the cover.
- 7)** Remove the circuit board from the top cover and place it in a protected, grounded area.
- 8)** Remove the damaged 31432 Window and 31183 O-ring gasket from the inside of the top cover.
- 9)** Clean the sealing areas for the 31183 O-ring Gasket and the 26211 Gasket on the top cover. Any contamination can cause seal failure and allow moisture to enter the meter. **MOISTURE IN THE METER WILL CAUSE METER FAILURE.**

Reassemble the Meter (11 steps).

- 1) Place the new 31183 O-ring Gasket around the protrusion on the front of the new 31432 Window then place the window and o-ring into the top cover.
- 2) Place the circuit board on the window and replace the four 31640 Torx Head Screws and tighten to **15 inch/pounds**. For ease of installation, the screw for the inter-board ground wire can be replaced after the gasket.
- 3) Remove the liner from the gasket and carefully align the holes in the gasket with the holes in the top cover, then press into place.
- 4) Be sure that all four Torx head screws are tight and that the ground wire is connected to the screw nearest the programming port. Be certain that the ground wire will not interfere with the gasket seal.
- 5) Reinstall the ribbon cable if it was removed.
- 6) Plug in the battery and replace the old desiccant packs with the new packs provided.
- 7) If your meter has a loose or damaged foam battery restraint of the type provided, replace it now. Take care to place the notch in the same corner as the ribbon cable. Not all meters will have this additional battery restraint. **Only install the supplied foam battery restraint if your meter was originally supplied with one.**

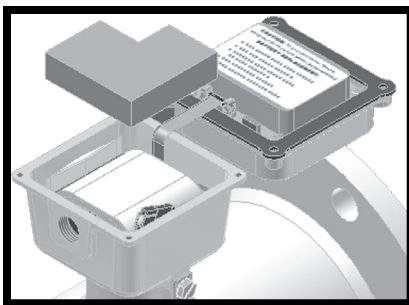

Top Cover open. Optional foam battery restraint shown.

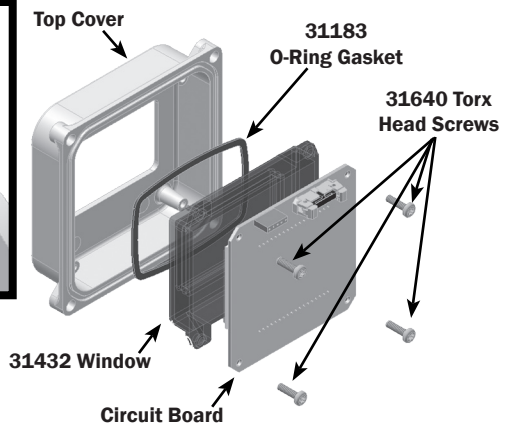

Continues on back page

8) Replace the top cover so that the bottom of the display is oriented towards the wiring access plug and that nothing is in the gasket sealing area.

REMEMBER THAT CONTAMINATION IN THE GASKET SEAL WILL CAUSE SEAL FAILURE WHICH WILL RESULT IN METER FAILURE.

9) Loosely install the four 31350 socket head screws with washers. If your meter had a security seal, be sure the 2 screws with the cross drilled holes are nearest the access plug.

Cross drilled security screws are not supplied and must be ordered seperately.

10) Sequentially tighten the screws in an X pattern. The final torque should be 15 inch/pounds. If your meter has security screws align the cross drilled holes so they will accept the security wire.

11) Finally, if your meter had a security seal, install the replacement seal and record the number.

